

COMPLETION Q2 2020



SHOE LANE
LONDON

66SHOELANE.CO.UK

73,980 SQ FT
PRE-LET TO
DELOITTE
DIGITAL

78,742 SQ FT
AVAILABLE
Q2 2020

FLOOR	NIA SQ FT*
5	18,094
4	18,094
3	18,094
2	18,094
LG	3,821
RECEPTION	2,545
TOTAL	78,742

- Dedicated entrance hall for available floors (separate from Deloitte)
- 3 x dedicated 18 person lifts
- Occupational density of 1:8m²
- 3.3m floor to soffit ceiling height
- Exposed 4-pipe fan coil air conditioning system
- Raised floors (150mm overall)
- 3m deep terraces on upper floors
- BREEAM 'Excellent'

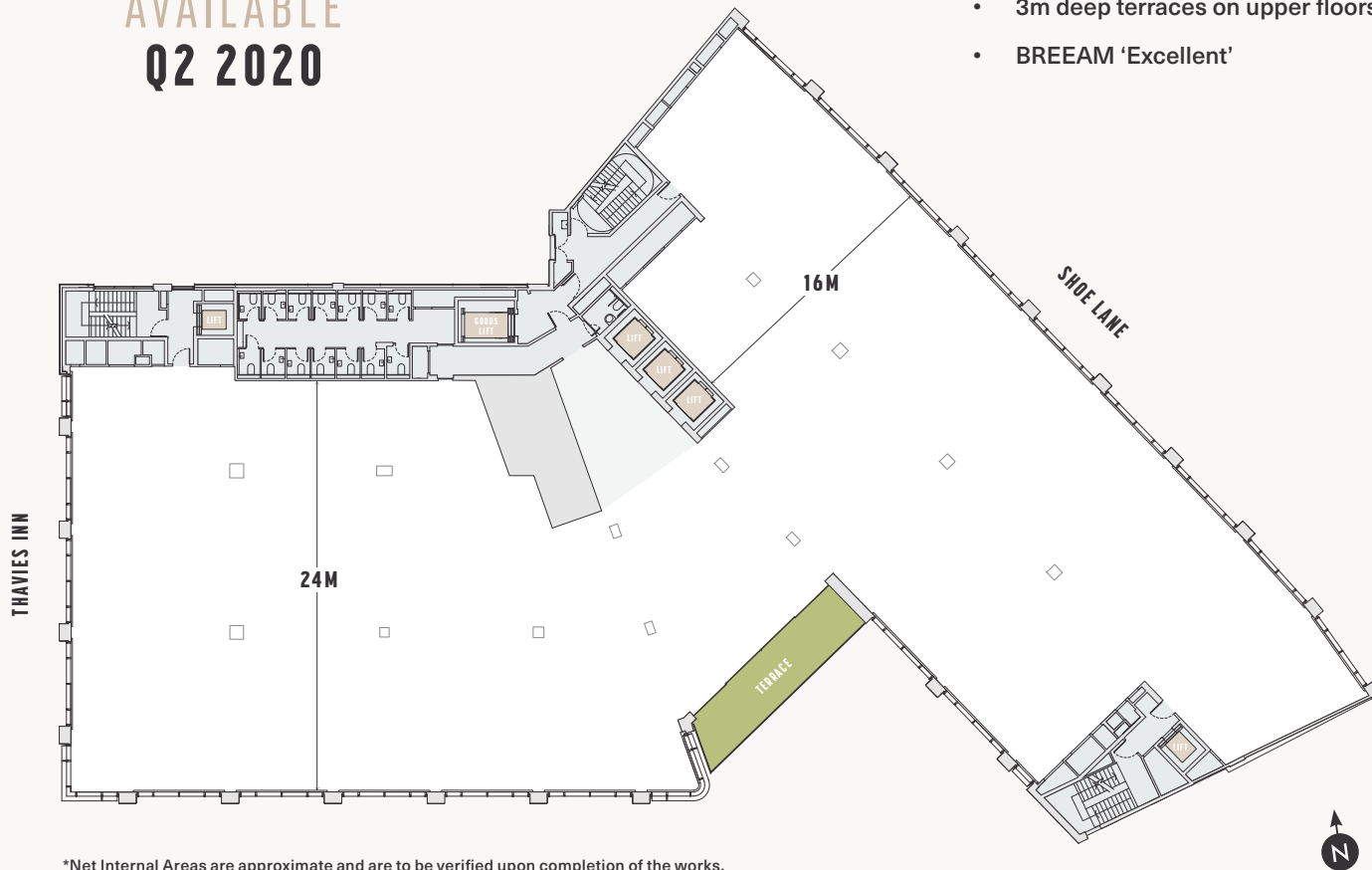

*Net Internal Areas are approximate and are to be verified upon completion of the works.



FOR MORE INFORMATION, PLEASE CONTACT:

BH₂

CBRE

SAM BOREHAM
020 7710 7963
samb@bh2.co.uk

CHRIS VYDRA
020 7182 3143
chris.vydra@cbre.com

DAN ROBERTS
020 7710 7958
danr@bh2.co.uk

JACK KNIVETT
020 7182 3615
jack.knivett@cbre.com

ADAM COSGROVE
020 7182 2447
adam.cosgrove@cbre.com

**HENDERSON
PARK**

**ENDURANCE
LAND**

IMPORTANT NOTICE RELATING TO THE MISREPRESENTATION ACT 1967 AND THE PROPERTY MISDESCRIPTIONS ACT 1991 CBRE and BH2 on behalf and for the lessors of this property whose agents they are, give notice that: The particulars are set out as a general outline only for guidance of intending lessees and do not constitute, nor constitute part of, an offer or contract. May 2019. SUBJECT TO CONTRACT.